

# ROMANTIC RHINE EUROPEAN RIVER CRUISE

FEATURING HOLLAND, GERMANY, FRANCE & SWITZERLAND



## Join Rod & Deb from Greenland Garden Centre on a Spring River Cruise.

Your spring river cruise vacation includes stays in Holland, Germany, France, and Switzerland – all beginning with your Avalon Rhine River cruise embarking from Amsterdam. Relax on the Sky Deck of your ship as you pass through the spectacular Rhine Gorge – the most beautiful view of the Rhine River where ancient castles stand on cliffs 400 feet above the water. We'll finish the river cruise with 3 post nights in Lucerne, Switzerland.

**April 17<sup>th</sup> – 29<sup>th</sup>**



## Newwest Travel - Greenland European River Cruise Includes:

- ❖ Round-trip international airfare from Edmonton to Europe with KLM
- ❖ 12-day river cruise & tour with sightseeing, outings, and excursions with local guides
- ❖ 1-pre cruise nights in Amsterdam with breakfast
- ❖ 7-nights' onboard the award-winning [Avalon Vista](#) river cruise ship. (April 19<sup>th</sup> – 26<sup>th</sup>)
- ❖ 3-post cruise nights in Lucerne with daily breakfast
- ❖ Meals included onboard the ship: Daily full buffet breakfast; Daily lunch buffet; Daily a la carte dinner in the main Dining Room (Complimentary sparkling wine with breakfast; wine, beer, or soft drinks with every lunch and dinner)
- ❖ Pre-paid gratuities for the ship crew and cruise director onboard the ship. (Any service off the ship; tips are not included)
- ❖ Private transfers in Amsterdam & Lucerne for arrival & departure
- ❖ Escorted by Rod & Deb from Greenland Garden Centre
- ❖ Complimentary parking at Value Park at Edmonton International Airport
- ❖ Bon Voyage reception with the group in Edmonton prior to the tour

**Pre & post stays can be quoted at time of booking.**

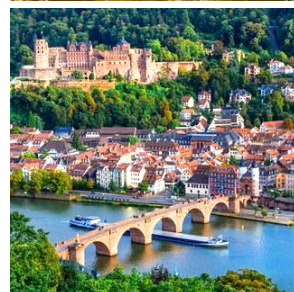

**Exclusive Promotion: Reserve your Greenland River Cruise & Tour by May 31<sup>st</sup> to save \$1000 per person off the listed rates!**



## Greenland River Cruise Package:

### Single Occupancy

Category E Deluxe Stateroom	\$13,670
Category B Panorama Suite	\$16,305
Category A Panorama Suite	\$16,395
Category P Panorama Suite	\$16,475

### Double Occupancy

Category E Deluxe Stateroom	\$10,260
Category B Panorama Suite	\$11,960
Category A Panorama Suite	\$12,050
Category P Panorama Suite	\$12,150

Prices are per person based on room occupancy; all taxes included.

Tour prices are subject to change without notice. Prices are per person based on room occupancy and are non-refundable. Seat upgrades on the airline may be available. This tour includes moderate physical activity. The itinerary blends some longer days and shorter days with more leisure time. Walking tours, as well as walking slightly longer distances, up-stairs or on uneven walking surfaces should be expected. Tour itinerary is subject to change. Past Globus Family of Brands travelers may qualify for an additional Welcome Back Credit, contact Newwest Travel for more information. [Read more about Newwest Travel's Terms & Conditions and Travel Disclaimers.](#)

**FOR MORE INFO AND RESERVATIONS PLEASE CONTACT NEWWEST  
1 (800) 661-7281 | (780) 432-7446 | [info@newwesttravel.com](mailto:info@newwesttravel.com) | [newwesttravel.com](http://newwesttravel.com)**





## Avalon Ship Features:

- Air-conditioned Panorama Lounge
- Complimentary specialty coffees including espresso and cappuccino available throughout the day
- Daily cocktail hour with cocktail of the day
- Complimentary water stations
- Open-air observation lounge with shade system & premium lounge chairs
- Bar serving premium spirits, wine & complimentary coffee, tea, soft drinks, and local beer/spirits throughout the day
- Complimentary Wi-Fi access in the lounges (where signal is available)
- Spa treatment room
- Non-smoking staterooms & ship interior
- Fitness Room
- Library and games
- English-speaking friendly crew, staff & professional Cruise Director
- Seasonal recipes featuring the freshest local ingredients
- Sightseeing with Expert Local Guides
- Vegetarian options available with all meals
- Onboard lectures, activities & entertainment
- Complimentary coffee, tea, soft drinks, local beer/spirits with all onboard meals
- Daily early-riser coffee & tea
- Daily a la carte breakfast
- Complimentary juices with breakfast
- Four-course à la carte dinners with choice of salads, soups, entrées, dessert or cheese
- Daily a la carte lunch including regional specialties, healthy Avalon Fresh options and classic dishes
- Complimentary wine with all onboard lunches & dinners
- Chef-prepared onboard meals with regional cuisine and familiar favorites
- Headsets for all guided shore excursions
- Behind-the-scenes galley tour
- Choice of Classic, Active or Discovery excursions so that you can experience your cruise your way
- Flatscreen satellite TV with English-speaking channels & over 100 free movie options
- Onboard assistance is available to recommend, reserve and further personalize your cruise

## Avalon Deluxe Stateroom (Category E)



PHOTO SHOWN IS REPRESENTATIVE OF A STATEROOM IN THE CATEGORY

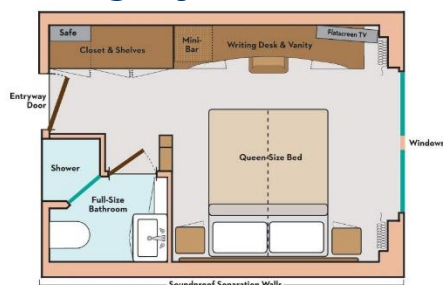

- Complimentary Wi-Fi
- USB Ports
- Lighted makeup mirror
- One Queen-Sized Bed or Two Twins
- Two windows
- Egyptian super-combed cotton linens
- Comfort Collection Beds
- European-style duvets
- Soft & firm pillows
- Extra blankets
- Hairdryer
- Nightly turn-down service
- Spacious 3-door closets with shelves
- Flatscreen satellite TV with English-speaking channels & over 100 free movie options
- Direct-dial telephone
- Bathrobes & slippers
- Complimentary filtered water
- In-room safe
- Elegant, contemporary design
- Full shower with glass door
- Writing desk and chair
- Luxurious mattress toppers
- Choice of bed configuration
- Bedside tables with reading lamps
- L'Occitane bath products
- Easy under-bed luggage storage
- Alarm clock
- Individual climate control
- Large mirror in bathroom
- Well-stocked minibar

## Avalon Panorama Suite (Category B, A or P)



PHOTO SHOWN IS REPRESENTATIVE OF A STATEROOM IN THE CATEGORY

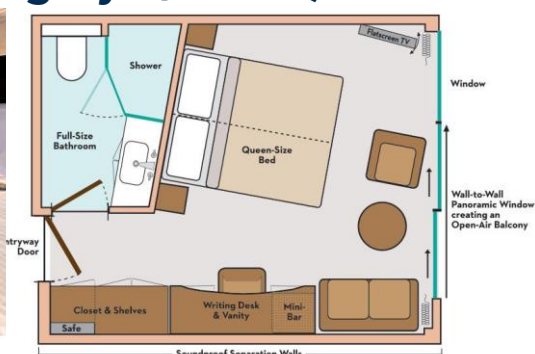



- Complimentary Wi-Fi
- USB Ports
- Lighted makeup mirror
- One Queen-Sized Bed or Two Twins
- Make-up mirror
- 6-person sitting area
- Marble countertops in bathroom
- Wall-to-Wall Panoramic Window with Open-Air Balcony
- Sofa
- Coffee table
- Egyptian super-combed cotton linens
- Comfort Collection Beds
- European-style duvets
- Soft & firm pillows
- Extra blankets
- Hairdryer
- Nightly turn-down service
- Spacious 3-door closets with shelves
- Flatscreen satellite TV with English-speaking channels & over 100 free movie options
- Direct-dial telephone
- Bathrobes & slippers
- Complimentary filtered water
- In-room safe
- Elegant, contemporary design
- Full shower with glass door
- Writing desk and chair
- Luxurious mattress toppers
- Choice of bed configuration
- Bedside tables with reading lamps
- L'Occitane bath products
- Easy under-bed luggage storage
- Alarm clock
- Individual climate control
- Large mirror in bathroom
- Well-stocked mini bar

## Avalon Vista Suite Ship

*The Avalon suites features two full decks of Panorama Suites with wall-to-wall, floor-to-ceiling panoramic windows that transform the living space into river cruising's only Open-Air Balcony. Enjoy seamless views from your Comfort Collection bed that faces the window. With 200 square feet, Panorama Suites are more than 30% larger than the industry standard, affording you the space to entertain in your private sitting area or just relax and enjoy the passing vistas. Onboard amenities include a Fitness Center, complimentary computer use in public areas and complimentary Starlink Wi-Fi access, and a spacious Sky Deck with premium lounge chairs, shade system, whirlpool, and the delightful Sky Bistro. Sweeping views are yours to enjoy on the Avalon Vista!*

