

# SPRING RIVER CRUISE PRAGUE TO BUDAPEST



Join Rod and Deborah From Greenland Garden Centre on a River Cruise & Tour along the Picturesque Danube River April 21<sup>st</sup> – May 4<sup>th</sup>, 2019

## Greenland Garden Centre River Cruise Includes:

- Round-trip airfare from Edmonton with KLM
- 13-day river cruise & tour with sightseeing, outings and excursions with local guides
- 3 nights pre-cruise accommodation in Prague with a meet and greet and daily breakfast
- 7 nights accommodation onboard the luxurious Avalon Illumination
- 2 nights post-cruise accommodation in Budapest with daily breakfast
- Meals included onboard the ship: Daily full buffet breakfast; Daily lunch buffet; Daily four-course a la carte dinner in the main Dining Room (*Complimentary sparkling wine with breakfast; wine, beer, or soft drinks with every lunch and dinner*)
- 2 additional tours added onto to the itinerary (Traditional Czech dinner in Prague and a guided excursion to Schönbrunn Palace & Garden in Vienna)
- Private round-trip airport/cruise transfers and pre-paid gratuities onboard the ship
- Escorted by Rod & Deborah from Greenland Garden Centre
- Bon Voyage reception at Greenland Garden Centre in Edmonton prior to departure



Pricing Per Person	Single Occupancy	Double Occupancy	Taxes Included
Category D Stateroom	\$7,667.00	\$5,825.00	✓
Category A Panorama Suite	On Request	\$6,885.00	✓

*Tour prices are subject to change without notice. Prices are per person based on room occupancy and are non-refundable. Extended stays are available, please inquire with Newwest Travel. Upgrades to Premium Economy and Business Class airfare are available. This tour includes moderate physical activity. The itinerary blends some longer days and shorter days with more leisure time. Walking tours, as well as walking slightly longer distances, up-stairs or on uneven walking surfaces should be expected. Tour itinerary is subject to change.*



**FOR MORE INFO AND RESERVATIONS PLEASE CONTACT NEWWEST TRAVEL**  
1 800-661-7281 | 780-432-7446 | [info@newwesttravel.com](mailto:info@newwesttravel.com) | [newwesttravel.com](http://newwesttravel.com)

## Included Onboard Amenities:

### Avalon Suite Fleet

- Complimentary Wi-Fi throughout the ship
- Panoramic windows throughout the ship
- Elegant, contemporary design & decor
- Friendly, English-speaking crew & Cruise Director
- Sky Deck with whirlpool, shade awnings, game area and premium lounges
- Covered Observation Lounge
- Club Lounge with 24-hour self-serve beverage station with complimentary cappuccinos, lattes, tea, hot chocolate & premium coffees, as well as treats throughout the day
- Elevator
- Non-smoking interior

### Fitness & Wellness

- Fitness Center
- Avalon Adventure Center  
Your place for active gear and excursions, including
  - Bikes
  - Canoe, kayak and jogging excursions
  - Maps for hiking, biking and jogging routes
  - Fitness and wellness activities
  - FitBits®
- Active shore excursions, both included and optional

### Dining

- FlexDining for more venue and seating options, including flexible seating times in our main Dining Room
- Avalon Fresh healthy cuisine options at every meal
- Complimentary sparkling wine with breakfast; wine, beer, or soft drinks with every lunch and dinner
- Early and Late Riser breakfast options
- Daily full buffet breakfast with made-to-order egg station, hot and cold menu items
- Daily lunch buffet with pasta or carving stations
- Alternative light lunch or Sky Grill on the Sky Deck (weather permitting)
- Daily Afternoon Tea featuring tea, coffee, sweet treats & sandwiches
- Daily four-course a la carte dinner in the main Dining Room with choice of appetizers, soups, salads, entrees and desserts. Includes selections of regional recipes, Western dishes and vegetarian options.
- Alternative Panorama Bistro dinner, featuring regional specialties and small plates
- Captain's welcome & farewell receptions and dinners with sparkling wine and canapés
- Panorama Lounge featuring premium spirits and Avalon specialty cocktails, along with local entertainment
- Cocktails available on the Sky Deck
- Fresh fruit available throughout the day

## Panorama Suite (Category A) - 200 sq. ft.

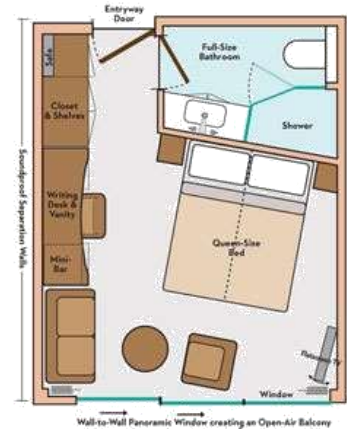

### Features

- Comfort Collection Beds with Egyptian cotton linens
- Soft & firm pillows
- Choice of bed configuration
- Bedside tables with reading lamps
- L'Occitane bath products
- Easy under-bed luggage storage
- Alarm clock & direct-dial telephone
- Well-stocked minibar
- In-room safe
- Marble countertops in bathroom with hairdryer
- Wall-to-Wall Panoramic Window with Open-Air Balcony
- Full shower with glass door
- Vanity and lighted makeup mirror
- Coffee table
- Luxurious mattress toppers
- European-style duvets
- Nightly turn-down service
- Spacious 3-door closets with shelves for storage
- Flat screen satellite TV with English-speaking channels & over 100 free movie options
- Make-up mirror
- Bathrobes & slippers
- Complimentary bottled water
- Individual climate control
- Complimentary Wi-Fi
- 6-person sitting area
- Writing desk and chair



## Deluxe Stateroom (Category D) - 172 sq. ft.

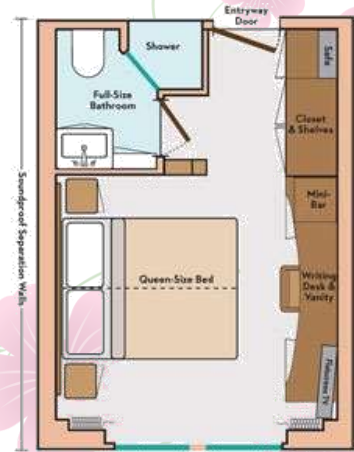

### Features

- Comfort Collection Beds
- Egyptian super-combed cotton linens
- Soft & firm pillows
- Choice of bed configuration
- Bedside tables with reading lamps
- L'Occitane bath products
- Easy under-bed luggage storage
- Alarm clock
- Bathrobes & slippers
- Complimentary bottled water
- Individual climate control
- Large mirror in bathroom
- Two windows
- Writing desk and chair
- Luxurious mattress toppers
- European-style duvets
- Extra blankets
- Nightly turn-down service
- Hairdryer
- Spacious 3-door closets with shelves for ample storage
- Flatscreen satellite TV with English-speaking channels & over 100 free movie options
- Direct-dial telephone
- Well-stocked minibar
- In-room safe
- Elegant, contemporary design
- Complimentary Wi-Fi
- Full shower with glass door
- Vanity and lighted makeup mirror



- ① = Overnights
- = Start City
- = End City