

BONJOUR BORDEAUX

Chateaux's, Wineries & Charming Villages of France



Join Rod & Deb from Greenland Garden Centre on a Vineyard River Cruise!
Bid bonjour to the bountiful beauty of Bordeaux with a captivating cruise on the Garonne and Dordogne Rivers in one of France's most exquisite regions. Experience Avalon's signature included Classic, Active, or Discovery tours – from the regal histories of castles and Châteaux to the romantic cellars. We'll also explore San Sebastián, known for its picturesque bayfront promenade, and world-renowned Spanish restaurants. **September 10th – 22nd, 2026**

Newwest Travel - Bonjour Bordeaux River Cruise Includes:

- ❖ Round-trip international airfare from Edmonton to Europe with KLM
- ❖ 12-day river cruise & tour with sightseeing, outings, and excursions with local guides
- ❖ 3-pre cruise nights in San Sebastián, Spain with daily breakfast
- ❖ 1-pre cruise night in Bordeaux with breakfast
- ❖ 7-nights' onboard the award-winning [Avalon Artistry II](#) river cruise ship (September 15th – 22nd)
- ❖ **Meals included onboard the ship:** Daily full buffet breakfast; Daily lunch buffet; Daily a la carte dinner in the main Dining Room (Complimentary sparkling wine with breakfast; wine, beer, or soft drinks with every lunch and dinner).
- ❖ Pre-paid gratuities for the ship crew and cruise director onboard the ship. (Any service off the ship; tips are not included).
- ❖ Private airport transfers in San Sebastián and Bordeaux for arrival & departure
- ❖ Escorted by Rod & Deb from Greenland Garden Centre
- ❖ Complimentary parking at JetSet Valet at Edmonton International Airport
- ❖ Bon Voyage reception with the group at Branches in Greenland Garden Centre

Exclusive Promotion: Reserve your Bonjour Bordeaux River Cruise & Tour by July 30th to save \$1,100 per person off the listed rates!

Bonjour Bordeaux River Cruise Package:	
Single Occupancy	Double Occupancy
Category E/D Deluxe Stateroom \$17,265	Category E/D Deluxe Stateroom \$12,145
Category B Panorama Suite \$20,520	Category B Panorama Suite \$14,250
Category A Panorama Suite \$20,595	Category A Panorama Suite \$14,295
Category P Panorama Suite \$20,750	Category P Panorama Suite \$14,370

Prices are per person based on room occupancy in CAD\$; all taxes included.

Tour prices are subject to change without notice. Prices are per person based on room occupancy and are non-refundable. Seat upgrades on the airline may be available. This tour includes moderate physical activity. The itinerary blends some longer days and shorter days with more leisure time. Walking tours, as well as walking slightly longer distances, up-stairs or on uneven walking surfaces should be expected. Tour itinerary is subject to change. Past Globus Family of Brands travelers may qualify for an additional Welcome Back Credit, contact Newwest Travel for more information. [Read more about Newwest Travel's Terms & Conditions and Travel Disclaimers.](#)

FOR MORE INFO AND RESERVATIONS PLEASE CONTACT NEWWEST
1 (800) 661-7281 | (780) 432-7446 | info@newwesttravel.com | newwesttravel.com



Avalon Ship Features:

- Air-conditioned Panorama Lounge
- Complimentary specialty coffees including espresso and cappuccino available throughout the day
- Daily cocktail hour with cocktail of the day
- Complimentary water stations
- Open-air observation lounge with shade system & premium lounge chairs
- Bar serving premium spirits, wine & complimentary coffee, tea, soft drinks, and local beer/spirits throughout the day
- Complimentary Starlink Wi-Fi access (where signal is available)
- Spa treatment room
- Non-smoking staterooms & ship interior
- Fitness Room
- Library and games
- English-speaking friendly crew, staff & professional Cruise Director
- Seasonal recipes featuring the freshest local ingredients
- Sightseeing with Expert Local Guides
- Vegetarian options available with all meals
- Onboard lectures, activities & entertainment
- Complimentary coffee, tea, soft drinks, local beer/spirits with all onboard meals
- Daily early-riser coffee & tea
- Daily a la carte breakfast
- Complimentary juices with breakfast
- Four-course à la carte dinners with choice of salads, soups, entrées, dessert or cheese
- Daily a la carte lunch including regional specialties, healthy Avalon Fresh options and classic dishes
- Complimentary wine with all onboard lunches & dinners
- Chef-prepared onboard meals with regional cuisine and familiar favorites
- Headsets for all guided shore excursions
- Behind-the-scenes galley tour
- Choice of Classic, Active or Discovery excursions so that you can experience your cruise your way
- Flatscreen satellite TV with English-speaking channels & over 100 free movie options
- Onboard assistance is available to recommend, reserve and further personalize your cruise

Avalon Deluxe Stateroom (Category D or E)

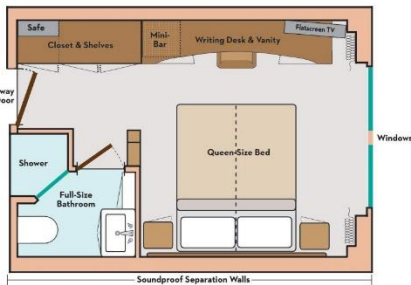

- Complimentary Starlink Wi-Fi
- USB Ports
- Lighted makeup mirror
- One Queen-Sized Bed or Two Twins
- Two windows
- Egyptian super-combed cotton linens
- Comfort Collection Beds
- European-style duvets
- Soft & firm pillows
- Extra blankets
- Hairdryer
- Nightly turn-down service
- Spacious 3-door closets with shelves
- Flatscreen satellite TV with English-speaking channels & over 100 free movie options
- Direct-dial telephone
- Bathrobes & slippers
- Complimentary filtered water
- In-room safe
- Elegant, contemporary design
- Full shower with glass door
- Writing desk and chair
- Luxurious mattress toppers
- Choice of bed configuration
- Bedside tables with reading lamps
- L'Occitane bath products
- Easy under-bed luggage storage
- Alarm clock
- Individual climate control
- Large mirror in bathroom
- Well-stocked minibar

Avalon Panorama Suite (Category B, A or P)

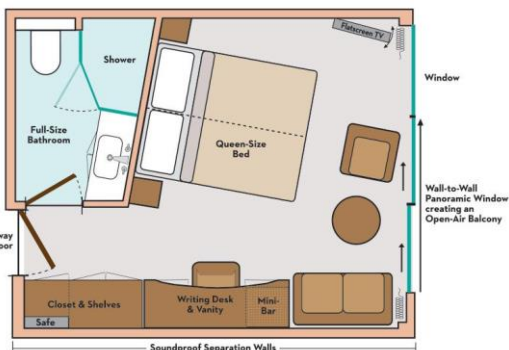

- Complimentary Starlink Wi-Fi
- USB Ports
- Lighted makeup mirror
- One Queen-Sized Bed or Two Twins
- Make-up mirror
- 6-person sitting area
- Marble countertops in bathroom
- Wall-to-Wall Panoramic Window with Open-Air Balcony
- Sofa
- Coffee table
- Egyptian super-combed cotton linens
- Comfort Collection Beds
- European-style duvets
- Soft & firm pillows
- Extra blankets
- Hairdryer
- Nightly turn-down service
- Spacious 3-door closets with shelves
- Flatscreen satellite TV with English-speaking channels & over 100 free movie options
- Direct-dial telephone
- Bathrobes & slippers
- Complimentary filtered water
- In-room safe
- Elegant, contemporary design
- Full shower with glass door
- Writing desk and chair
- Luxurious mattress toppers
- Choice of bed configuration
- Bedside tables with reading lamps
- L'Occitane bath products
- Easy under-bed luggage storage
- Alarm clock
- Individual climate control
- Large mirror in bathroom
- Well-stocked mini bar

Avalon Artistry II Suite Ship

Part of Avalon's award-winning fleet of Suite Ships, the Avalon Artistry II features two full decks of Panorama Suites with wall-to-wall, floor-to-ceiling panoramic windows that transform the living space into river cruising's only Open-Air Balcony. With 200 square feet, Panorama Suites are more than 30% larger than the industry standard, affording you the incomparable opportunity to wake each morning to splendid passing scenery from your window-facing bed. Stretch out on your Comfort Collection bed and cruise with the world at your feet. Onboard amenities include an alternative light dining option in the Panorama Bistro, a Fitness Center, complimentary Wi-Fi access, and a spacious Sky Deck with premium lounge chairs, whirlpool, and light al fresco lunches at the Sky Bistro on the Sky Deck. A true work of art in relaxed luxury on board and amazing adventures on shore!

