

# DANUBE DREAMS RIVER CRUISE

BUDAPEST TO MUNICH WITH



**Join 840 CFCW's A.J. Keller on a 14-day Autumn River Cruise.** Experience this river cruise itinerary along the peaceful Danube River through Hungary, Slovakia, Austria, and Germany—discovering some of Central Europe's most splendid capitals and charming towns along the way. Enjoy the magnificent views as your river cruise takes you through the picturesque wine region of the Wachau Valley. Our final stop will be in Munich for the famous Oktoberfest celebration to enjoy live music, German cuisine, and beer! **September 17<sup>th</sup> - October 1<sup>st</sup>**



## Newwest Travel - CFCW European River Cruise Includes:

- ❖ Round-trip international airfare from Edmonton to Europe with KLM
- ❖ 14-day river cruise & tour with sightseeing, outings, and excursions with local guides
- ❖ 3-pre cruise nights in Budapest with daily breakfast
- ❖ 7-nights' onboard the award-winning [Avalon Passion](#) river cruise ship. (September 21<sup>st</sup> – 28<sup>th</sup>)
- ❖ 3-post cruise nights in Munich with daily breakfast and a visit to Oktoberfest
- ❖ Meals included onboard the ship: Daily full buffet breakfast; Daily lunch buffet; Daily a la carte dinner in the main Dining Room (Complimentary sparkling wine with breakfast; wine, beer, or soft drinks with every lunch and dinner)
- ❖ Pre-paid gratuities for the ship crew and cruise director onboard the ship. (Any service off the ship; tips are not included)
- ❖ Private transfers in Budapest & Munich for arrival & departure
- ❖ Escorted by CFCW's A.J. Keller for the duration of the tour
- ❖ Complimentary parking at Value Park at Edmonton International Airport
- ❖ Bon Voyage reception with the group in Edmonton prior to the tour

**Pre & post stays can be quoted at time of booking.**

**Exclusive Promotion: Reserve your CFCW River Cruise & Tour by March 1<sup>st</sup> to save \$1200 per person off the listed rates!**

## CFCW Danube Dreams River Cruise Package:

### Single Occupancy

Category E Deluxe Stateroom	\$15,755
Category A Panorama Suite	\$18,465
Category P Panorama Suite	\$18,550

### Double Occupancy

Category E Deluxe Stateroom	\$11,280
Category A Panorama Suite	\$13,025
Category P Panorama Suite	\$13,175

*Prices are per person based on room occupancy; all taxes included.*

Tour prices are subject to change without notice. Prices are per person based on room occupancy and are non-refundable. Seat upgrades on the airline may be available. This tour includes moderate physical activity. The itinerary blends some longer days and shorter days with more leisure time. Walking tours, as well as walking slightly longer distances, up-stairs or on uneven walking surfaces should be expected. Tour itinerary is subject to change. Past Globus Family of Brands travelers may qualify for an additional Welcome Back Credit, contact Newwest Travel for more information. [Read more about Newwest Travel's Terms & Conditions and Travel Disclaimers.](#)

**FOR MORE INFO AND RESERVATIONS PLEASE CONTACT NEWWEST**  
 1 (800) 661-7281 | (780) 432-7446 | [info@newwesttravel.com](mailto:info@newwesttravel.com) | [newwesttravel.com](http://newwesttravel.com)





## Avalon Ship Features:

- Air-conditioned Panorama Lounge
- Complimentary specialty coffees including espresso and cappuccino available throughout the day
- Daily cocktail hour with cocktail of the day
- Complimentary water stations
- Open-air observation lounge with shade system & premium lounge chairs
- Bar serving premium spirits, wine & complimentary coffee, tea, soft drinks, and local beer/spirits throughout the day
- Complimentary Wi-Fi access in the lounges (where signal is available)
- Spa treatment room
- Non-smoking staterooms & ship interior
- Fitness Room
- Library and games
- English-speaking friendly crew, staff & professional Cruise Director
- Seasonal recipes featuring the freshest local ingredients
- Sightseeing with Expert Local Guides
- Vegetarian options available with all meals
- Onboard lectures, activities & entertainment
- Complimentary coffee, tea, soft drinks, local beer/spirits with all onboard meals
- Daily early-riser coffee & tea
- Daily a la carte breakfast
- Complimentary juices with breakfast
- Four-course à la carte dinners with choice of salads, soups, entrées, dessert or cheese
- Daily a la carte lunch including regional specialties, healthy Avalon Fresh options and classic dishes
- Complimentary wine with all onboard lunches & dinners
- Chef-prepared onboard meals with regional cuisine and familiar favorites
- Headsets for all guided shore excursions
- Behind-the-scenes galley tour
- Choice of Classic, Active or Discovery excursions so that you can experience your cruise your way
- Flatscreen satellite TV with English-speaking channels & over 100 free movie options
- Onboard assistance is available to recommend, reserve and further personalize your cruise

## Avalon Deluxe Stateroom (Category E)

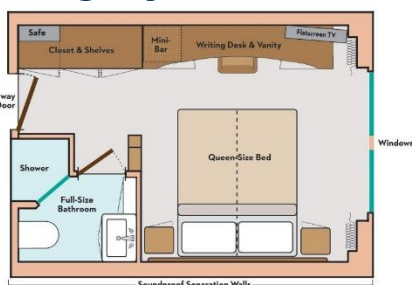

- Complimentary Wi-Fi
- USB Ports
- Lighted makeup mirror
- One Queen-Sized Bed or Two Twins
- Two windows
- Egyptian super-combed cotton linens
- Comfort Collection Beds
- European-style duvets
- Soft & firm pillows
- Extra blankets
- Hairdryer
- Nightly turn-down service
- Spacious 3-door closets with shelves
- Flatscreen satellite TV with English-speaking channels & over 100 free movie options
- Direct-dial telephone
- Bathrobes & slippers
- Complimentary filtered water
- In-room safe
- Elegant, contemporary design
- Full shower with glass door
- Writing desk and chair
- Luxurious mattress toppers
- Choice of bed configuration
- Bedside tables with reading lamps
- L'Occitane bath products
- Easy under-bed luggage storage
- Alarm clock
- Individual climate control
- Large mirror in bathroom
- Well-stocked minibar

## Avalon Panorama Suite (Category A or P)

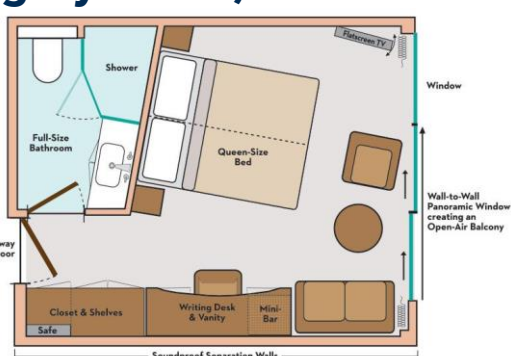

- Complimentary Wi-Fi
- USB Ports
- Lighted makeup mirror
- One Queen-Sized Bed or Two Twins
- Make-up mirror
- 6-person sitting area
- Marble countertops in bathroom
- Wall-to-Wall Panoramic Window with Open-Air Balcony
- Sofa
- Coffee table
- Egyptian super-combed cotton linens
- Comfort Collection Beds
- European-style duvets
- Soft & firm pillows
- Extra blankets
- Hairdryer
- Nightly turn-down service
- Spacious 3-door closets with shelves
- Flatscreen satellite TV with English-speaking channels & over 100 free movie options
- Direct-dial telephone
- Bathrobes & slippers
- Complimentary filtered water
- In-room safe
- Elegant, contemporary design
- Full shower with glass door
- Writing desk and chair
- Luxurious mattress toppers
- Choice of bed configuration
- Bedside tables with reading lamps
- L'Occitane bath products
- Easy under-bed luggage storage
- Alarm clock
- Individual climate control
- Large mirror in bathroom
- Well-stocked mini bar

## Avalon Passion Suite Ship

*We're so passionate about our Suite Ships, we christened this Suite Ship the Avalon Passion. Gracing Europe's waterways with style and relaxed luxury as only Avalon can deliver, the Avalon Passion lives up to its name. Avalon guests experience this passion for new discoveries aboard this home-away-from-home to find two full decks of Panorama Suites, featuring wall-to-wall, floor-to-ceiling panoramic windows that create river cruising's only Open-Air Balcony.*

*Spanning 200 square feet, the Passion's Panorama Suites are 30% larger than the industry standard. It's the perfect place to stretch out on your window-facing Comfort Collection bed with the world at your feet. Host a private cocktail party in the spacious sitting area-comfortably accommodating six guests. On board, passengers enjoy complimentary Starlink Wi-Fi access, complimentary computer use in public areas, a Fitness Center with state-of-the-art equipment, an elevator, and an expansive Sky Deck with shade system, premium lounge chairs, whirlpool, deck games, and the delightful Sky Bistro for al fresco lunches of light grill fare. Pack your own passions and cruise your way on the Avalon Passion.*

